



THUASNE®

UniReliever™

Osteoarthritis (OA)
Bracing Solutions

—
Offloading single-upright
knee brace

Designed for patients
with knee OA¹ who want
an **effective² brace**
to relieve their knee pain



UniReliever™

The most versatile OA knee brace in our range

EFFICIENT DYNAMIC OFFLOADING

- Crossing straps on the **unaffected** side which **creates two opposing forces** to **offload affected compartment**²

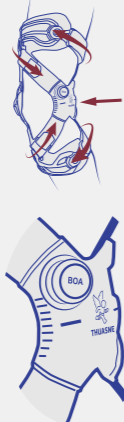

- 1 **Self-dosing adjustment via a dial** allows patient **self-management of pain**

- 2 **Single aluminum upright** on the affected side keeps the structure of the brace without preventing **3-point lever arm** and **creating targeted offload**

- 3 **Physiological TM5+ hinge**³ comes with extension stops (0-5-10-15-20-30°) and flexion stops in option (0-30-45-60-75-90-110°), with tools

PRACTITIONER FRIENDLY

- **One size fits all:** only 2 SKUs

- 4 **Semi-rigid shells** to accommodate various morphologies

- **Adjustable strap options:**



Trimable for length for **custom fit**
Ability to orientate allowing a **good fit** to different leg shapes



COMFORT

- **No strapping crossing at popliteal crease** creates **improved comfort** for patients with mild effusion or Baker's cyst³

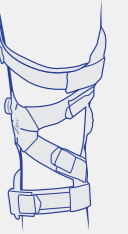

- 5 **Flexible semi-rigid femoral and tibial shells** provide an **intimate fit**

- **Silicone induction** on pads and straps **prevent migration & rotation**

- 6 **Alligator tabs** which enable **strap trimming** to the patient's morphology

- **Pivoting straps** at the back to **fully adapt to the leg shape** to avoid any folds and **prevent incorrect positioning** around the popliteal area

PATIENT FRIENDLY

- 7 **Quick buckles** for **easy application**³

- **Coloured and numbered sequential straps**

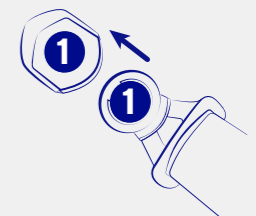

- **Lightweight device** = 420 gr

In depth fitting and tips & tricks for UniReliever™

The in depth fitting and tips & tricks information are provided to help you with the fitting of the UniReliever™ and provide advice and guidance to your patient.

Which brace do I need to choose? Always choose the brace for the affected side



- Pull the dial out before putting the brace on the patient's leg. The dial is always pushed in when the brace is first out of the box (default position). Make sure the dial is fully released before fitting.

- When the brace is on the leg, always check that the upright fits the leg well in the coronal plane. The hinge should lie close to the knee but shouldn't apply a corrective force. If needed, the upright can be shaped into varus or valgus.

- The hinge must be aligned with the middle of the patella for an optimal fit. Sagittally, the joint should be positioned slightly posterior to midline.



- **Cross buttress positioning is key in fitting.** It will ensure an efficient offloading and the comfort of the patient. Locate the patella and if needed draw its edge on the patient's leg. Then, draw a **reference point approximately 2 cm away from the edge of patella.** Position the cross buttress to the edge of your reference point and ask the patient to hold it in position while trimming the straps.



Make sure to also align the grey line horizontal with the midline of the patella.

- **Trimming of the straps:** all straps and strap pads are trimmable with simple scissors. Be careful – do not trim the self-fastening hook tab. Before trimming a strap, first position the self-fastening hook tab onto the inner part of the strap to help determine strap length.



Position the tab in the middle of the strap to keep room to increase or decrease strap tension!

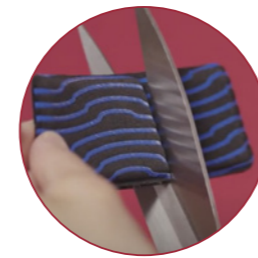

- Check the desired length, trim the strap and reattach the self-fastening hook tab.
- If needed, the strap pad length can be reduced by trimming it along the folding line.

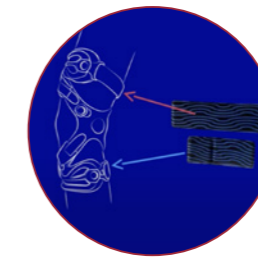

- If you remove the straps' paddings, note that: the shorter one is attached to the suspension strap (posterior strap, just below the popliteal area) and the longer one is attached to the most proximal strap.



- To apply the offloading, push the dial in, turn the dial clockwise and ask the patient to walk.



Start by a quarter turn
If needed, increase the offloading
The offloading is bigger in extension than in flexion: folds can appear on the cross buttress
If enough off load cannot be achieved, reassess the initial strap tightness, shorten straps slightly and then retry!

- Release the offloading by pulling the dial to completely remove offload or turn the dial counterclock-wise to reduce the load.
- Offloading can be adjusted depending on the need / pain level.

Do not hesitate to watch our detailed fitting instructions:



UniReliever™

A single upright OA knee brace to accommodate various patient types



PATIENT PROFILE

- Patient suffering from moderate to severe knee OA.
- Patient with medium to high activity level.
- Patient with ligament instabilities.
- Adapted to accommodate various morphologies.

MAIN INDICATIONS

- Symptomatic unicompartmental femorotibial osteoarthritis (moderate to severe).
- Knee offloading for post-traumatic, post-operative or degenerative conditions.
- Joint instability/laxity.
- Alternative to osteotomy or leg misalignment surgery.

MODES OF ACTION

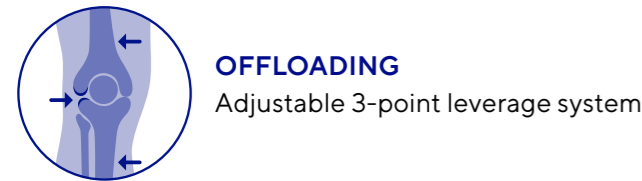

Overview of Thuasne® offloading range for knee OA



If the patient can be fitted with any of these braces, please make sure to choose, with their agreement, the device that is best suited to their expectations and needs (low profile, type of activity...)

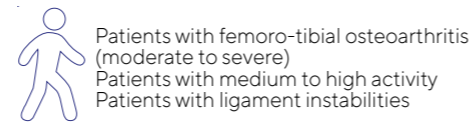
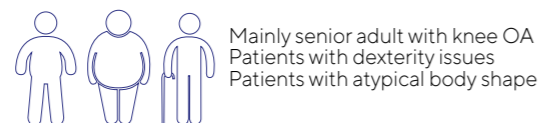

Thuasne® OA knee bracing solutions

A complete range to answer most of patient needs

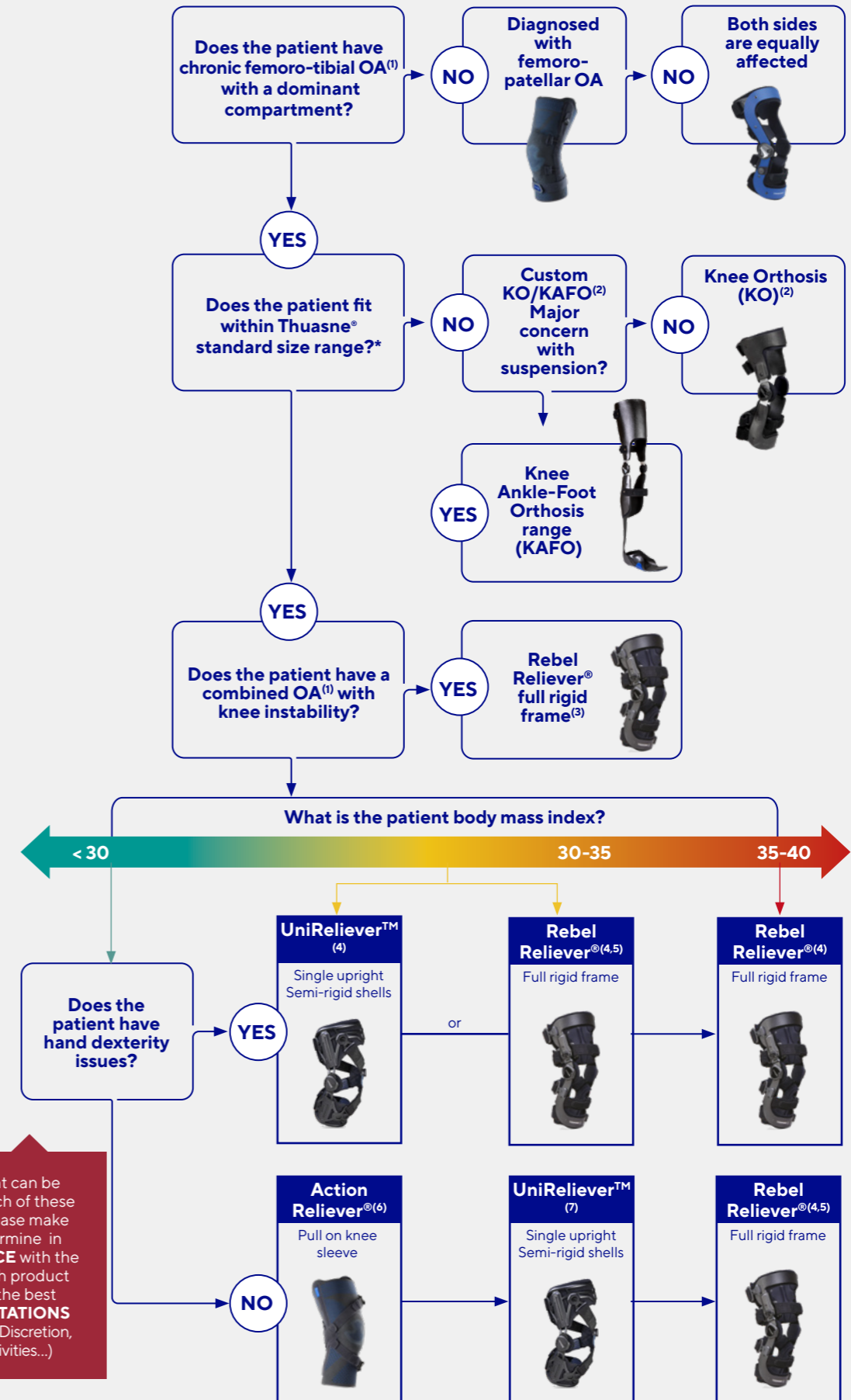

If the patient can be fitted with each of these products, please make sure to determine in **ACCORDANCE** with the patient, which product would suit the best their **EXPECTATIONS** and **NEEDS** (Discretion, Desired activities...)

* Max thigh circumference = 71 cm/28"
 (1) Osteoarthritis
 (2) KAFO: Knee-Ankle-Foot orthosis
 (3) Full rigid metallic frame with double upright
 (4) Semi-rigid shells with a metallic upright
 (5) Full rigid metallic frame with double upright
 (6) Soft fabric knee sleeve with straps and buckles that can be put on the leg without stepping through or pulling on
 (7) Open product with quick buckles that can be put on the leg without stepping through or pulling on
 (8) Thounnie Philippe, et al. "Effect of Unloading Brace Treatment on Pain and Function in Patients with Symptomatic Knee Osteoarthritis: The ROTOR Randomized Clinical Trial." Scientific Reports 8 (1): 10519.

UniReliever™



ONLY 2 VERSIONS:

Left Medial / Right Lateral (**U3090129900351**)

Right Medial / Left Lateral (**U3090129900352**)

Spare parts (straps, strap padding and paddings) for UniReliever™

Refurbishment kit for Left Medial / Right Lateral: **UU3090010001**

Refurbishment kit for Right Medial / Left Lateral: **UU3090010002**

(1) OA = Osteoarthritis.

(2) Michael Benning, Ralf-Dieter Hilgers, Stephanie Villet, Prasanna Shrestha and Nils Lynen. Efficacy and safety of a new offloading brace in the management of knee osteoarthritis. A randomized controlled UNIBRACE Study. 24th European congress of Physical and Rehabilitation Medicine - ESPRM. Ljubljana, Slovenia. 23-27 April 2024.

(3) Internal CE marking data.

(4) Lamberg, Eric M., Robert Streb, Marc Werner, Ian Kremenic, and James Penna. 2016b. "The 2-and 8-Week Effects of Decompressive Brace Use in People with Medial Compartment Knee Osteoarthritis." Prosthetics and Orthotics International 40 (4): 447-453. + Full rigid metallic frame with double upright

(5) Thoumie Philippe, et al. "Effect of Unloading Brace Treatment on Pain and Function in Patients with Symptomatic Knee Osteoarthritis: The ROTOR Randomized Clinical Trial." Scientific Reports 8 (1): 10519.

Availability of these products might vary from a given country or region to another, as a result of specific local regulatory approval or clearance requirements for sale in such country or region. All the medical devices mentioned on this document are CE marked according to the Regulation 2017/745 on medical devices, they are also UKCA-marked according to S.I 2002/618 regulation on medical devices. Medical devices mentioned in this document are CE class I. Please contact Thuasne® should you need any additional information on devices classification. Please carefully read the instructions for use, indications and contraindications of the products. The full list of medical indications, are available in the instructions for use. Last revision date: 02/2024. Ref: 2401046

Patella Reliever® - Action Reliever® - Rebel Reliever®:



Thuasne 120, rue Marius AUFAN
92300 Levallois-Perret
France

Rebel®:



Thuasne USA
4615 Shepard Street - Bakersfield, CA 93313
United-States



All products except Action Reliever® and Patella Reliever®:
UK Responsible Person (UKRP):
THUASNE UK Ltd
Unit 4 Orchard Business Centre
North Farm Road
Tunbridge Wells, TN2 3XF,
United Kingdom

UniReliever™ - SpryStep® KAFO - SpryStep® KO:



Thuasne Deutschland GmbH
Im Steinkamp 12
30938 Burgwedel - Deutschland



MedEnvoy Global BV
Prinnses Margrietplantsoen 33, Suite 123
2595 AM The Hague
The Netherlands